

Dawn Collins

Subject: T2 Kiosk

| | | | |
|------------------|---|---|-----|
| Kiosk Revenue | October Collections for the Kiosk / Transactions: 821 | | |
| | \$ 4,351.30 | Gross Collections | |
| | \$ (246.30) | Fees | |
| | \$ (1,130.00) | Supplies (Kiosk Paper)**reclassified supplies | |
| | \$ (900.00) | Annual Maintenance Contract**remove | |
| | \$ (70.00) | Monthly T2 Svc charge | |
| | \$ 2,005.00 | Net Collections - October | |
| | Collections 2023 YTD / YTD Transactions: 8108 | | |
| | \$ 42,972.40 | Gross Collections | |
| | \$ (2,388.40) | Fees | |
| | \$ (1,130.00) | Supplies (Kiosk Paper) | |
| | \$ (900.00) | Annual Maintenance Contract | |
| | \$ (744.00) | Monthly T2 Svc charge | |
| | \$ 37,810.00 | Net Collections | |
| | \$ (5,162.40) | Total Fees and Maintenance | 14% |

Dawn A. Collins, CMC
Town Administrator/Clerk



Town of Palmer Lake
42 Valley Crescent
PO Box 208
Palmer Lake CO 80133
719.481.2953
dawn@palmer-lake.org
www.townofpalmerlake.com

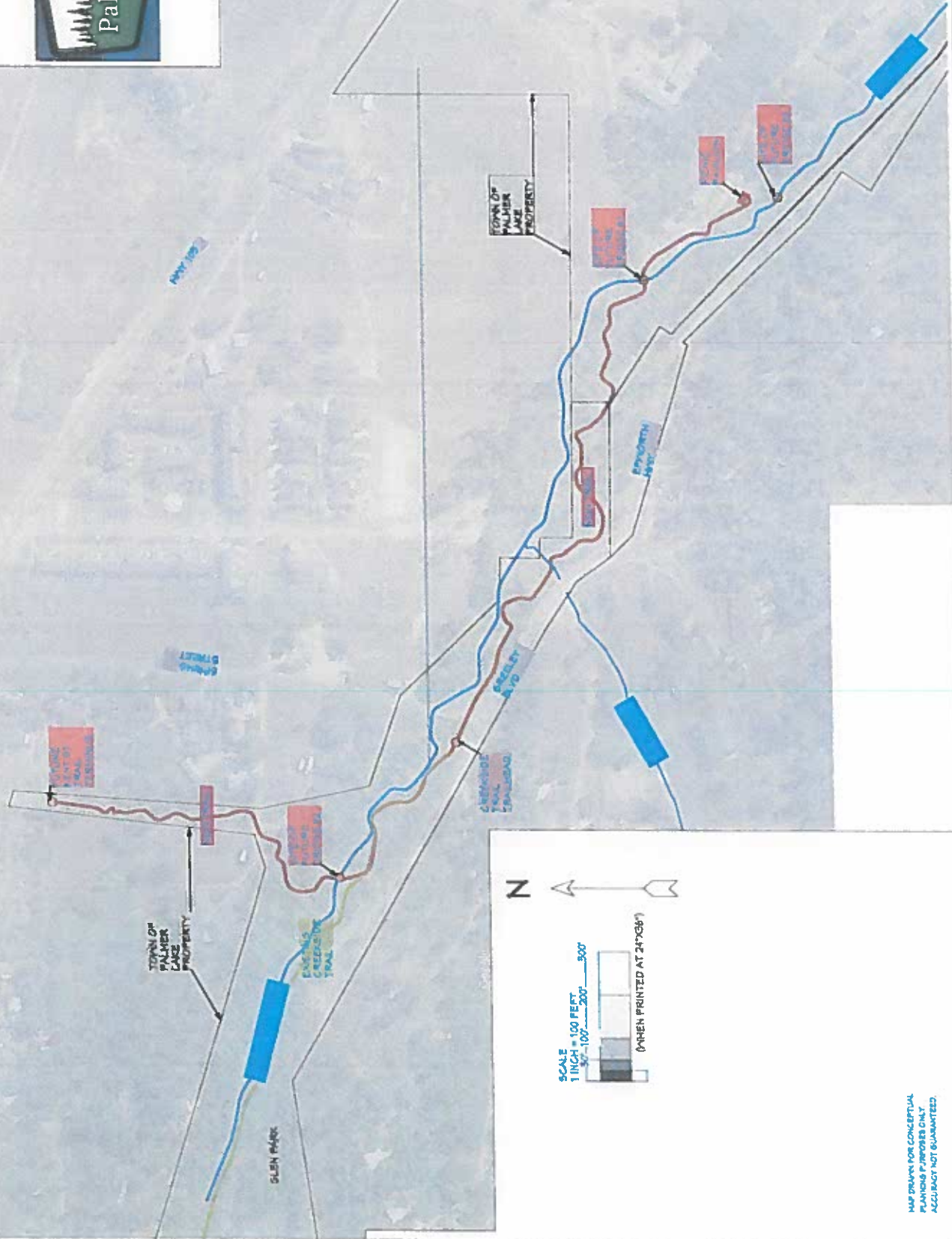

Parks Inventory, 11-14-2023

| # | Parks Shed | # | E-Rock storage |
|-------|--|-------|--|
| 34 | Cornhole bean bags - new | 25 | Safety vests |
| 25 | Safety vests | 3 | Aluminum cornhole sets |
| 1 | Aluminum cornhole set | 3 | Cornhole bean bag sets |
| 1 | Cornhole bean bag set | 2 | Wood cornhole sets |
| 15 pr | Work gloves | 18 pr | Work gloves |
| 3 pr | Boots | 1 | Bouncy house pump |
| 1 | Water cooler | 3' | Plastic playground curbing - Glen Park |
| 7 | Traffic cones | 1 | Weed sprayer |
| 1 | Spool smooth fence wire | 2 | 10'x100' rolls plastic sheeting |
| 1 | New tennis net | 1 | 6' x ? Roll landscape fabric |
| 40 | PL Street signs - to sell | 1 | Gas weed whacker - almost new |
| 1 | Chain link, S hook expander | 1 | Gas can for above w/gas |
| 4 | Loppers | 1 | Small box weed whacker stuff |
| 4 | Pruners | 1 | First aid kit |
| 1 | First aid kit | 1 | Seed/fertilizer hand spreader |
| 2 | Clip boards | 1 | Clip board |
| 1 | Box misc. fencing clips, signs.. | 1 | Used but good tennis net |
| 1 | Sm. Box misc paint | 1 | Bag of bags |
| 1 | Blk. plastic box playground info & tools | 1 | Hand sledge hammer mini |
| 3 | Rolls ext. cord w/timer - Xmas lights? | 1 | Hammer |
| 2 | Mountain lion CPW warning signs | 1 | Garden fork - hand held |
| 2 | Bear CPW warning signs | 2 | Trowels |
| 1 | Dock rules sign | 1 | Hand weed puller |
| 1 | Pet waste station sign | 2 | Hedge trimmers |
| 1 | Bag of plastic bags - lots | 1 | Bow saw |
| 1 | Bag of grass seed -old | 15 | Trail flags |
| 13 | Small foam play balls | 2 | 5- gallon buckets |
| 4 | Basketballs | 1 | Med-large tub |
| 3 | Volleyballs | 1 | Extra large tub |
| 6 | Broomball nets | 3 | Rakes |
| 1 | Tape measure | 2 | Small shovels |

| # | Parks Shed | # | E-Rock storage |
|-----|------------------------------------|-----|---|
| 1 | Hammer | 1 | Pulaski tool |
| 2 | Garden forks | 1 | Garden fork |
| 1 | Trowel | 1 | Flat shovel |
| 2 | dandelion weed puller | 1 | Leaf rake |
| 1 | Hand weeding tool | 1 | Regular shovel |
| 2 | Litter grabbers | 1 | Tiny blade shovel |
| 6-8 | Sun - safety glasses | 1 | Weeding tool |
| 3 | Pickle ball paddles | | |
| 1 | Pickle ball net | | |
| 1 | Bike - ball pump | | |
| 1 | Rake | | |
| 1 | Small shovel | | |
| | <u>Parks Shed Inventory</u> | | <u>Parks Shed inventory - additional</u> |
| 1 | Garden fork | | |
| 2 | Narrow hole shovels | 200 | New cold cups - Winterfest |
| 1 | Post hole digger | 2 | Winterfest donation cans |
| 1 | Tiny blade shovel | 1 | Blow up Santa |
| 1 | Short shovel | 3 | 5- gallon buckets |
| 1 | Extension cord | 1 | 10 ? Gallon tub |
| 2 | Road man flags - orange | 2 | Kitchen tongs |
| 12 | Hockey balls | 1 | Horseshoe set |
| 8 | Ping pong balls - old | 4 | Ping pong paddels |
| 2 | Bocci ball sets | 1 | Spike ball set |
| 6 | Plastic container tubs | 1 | Box misc playground stuff |